

RF-CP32

Instruction Manual

InnoWhite®

Professional Dental Whitening System

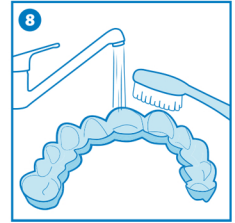
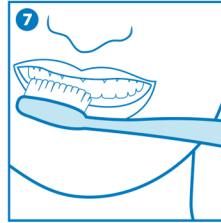
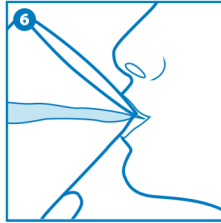
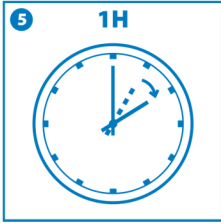
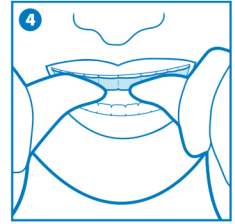
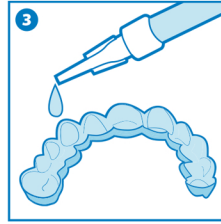
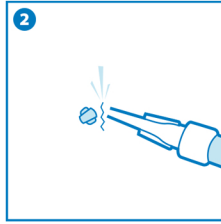
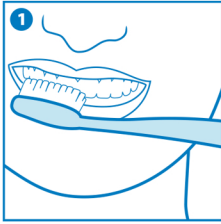

Step	EN	ES	JP	KR	CH	MY
1	Brush your teeth thoroughly	Cepílese los dientes a fondo	歯をしっかり磨いてください	이를 철저히 닦으십시오.	将牙齿彻底刷一遍	Berus gigi anda dengan teliti
2	Break the cap off the nozzle	Rompa el tapón de la punta dispensadora	ノズルのキャップを折って外します	노즐에서 캡을 떼어냅니다.	打破注射筒尖端的小帽	Pecahkan penutup muncun
3	Administer small amount of gel into front part of the tray	Dosifique 1 gota por diente en la cubeta	トレイの前部に少量のジェルを投与します	트레이 앞부분에 소량의 젤을 도포합니다.	在漂白牙套内为每一颗牙齿注入一滴增白剂	Masukkan sedikit gel ke hadapan dulang
4	Insert the bleaching tray into your mouth	Coloque la cubeta de blanqueamiento en la boca	漂白トレイを口の中に挿入します	미백 트레이를 입에 넣습니다.	将漂白牙套放入口腔	Masukkan dulang peluntur ke dalam mulut anda
5	Bleach for at least 30 mins	Blanquee los dientes al menos durante 30 minutos	少なくとも30分は漂白してください	최소 30 분 동안 표백	漂白至少30分钟	Luntur selama sekurang-kurangnya 30 minit
6	Rinse your mouth with water	Enjuáguese la boca con agua	水で口をすすぐ	물로 입을 헹구십시오.	用水漱口	Bilas mulut anda dengan air
7	Brush your teeth carefully	cepílese los dientes suavemente	丁寧に歯を磨きましょう	치아를 조심스럽게 닦으십시오.	小心地刷牙	Berus gigi dengan berhati-hati
8	Clean the bleaching tray with your toothbrush	Limpie las cubetas de blanqueamiento con el cepillo de dientes	歯ブラシで漂白トレイを掃除します	칫솔로 미백 트레이를 청소하십시오.	用牙刷清洗漂白牙套	Bersihkan dulang peluntur dengan berus gigi anda

DESCRIPTION

Hydrogen peroxide is the bleaching agent used in InnoWhite CP-Home Kit and RF-Refills. It is added as carbamide peroxide in order to obtain a sufficiently stable product. The carbamide peroxide breaks down rapidly into oxygen radicals and water. During the whitening process the free radicals attack the double carbon bonds that are the source of most colours (stains) in the tooth.

PACKAGING

InnoWhite Refill Syringe, 3ml

COMPOSITION

Active ingredients: 32% Carbamide Peroxide – equivalent to 10% hydrogen peroxide, 0.2 % Potassium nitrate and 0.1 % Sodium fluoride desensitizer.

INDICATIONS FOR USE

InnoWhite RF-Refills is a whitening product used to lighten the colour of natural teeth. InnoWhite RF-Refills should only be dispensed by or on the order of a dental professional to people over the age of 18. A consultation with a qualified dentist is recommended before beginning the whitening procedure to check for any underlying oral or health issues

CONTRAINDICATIONS

Any patient falling into one of the categories below is advised to consult a doctor prior to starting the treatment.

- Individual who is below 18 years old
- Pregnant and lactating women
- Those currently treated for a serious illness

CLINICAL PROCEDURE

- Record starting shade, review current dental health and make sure patient has realistic expectations about final results.
- Provisional or temporary restorations may discolour during the whitening process while composite or polycarbonate materials will remain unaffected. Therefore, patients with composite restorations must be advised that existing composites may require replacement, since only natural teeth will be whiten.
- For patients requiring aesthetic or adhesive restorations, wait 2 weeks after the last whitening treatment to allow for colour stabilization. All restorations should be intact or well-sealed with adequate temporary materials.
- The use of a sensitivity relief product starting 1 week prior to the treatment procedure until 1 week after the treatment should be advised.
- Patients should always be warned of tooth sensitivity or gingival irritation during the treatment. The gingival areas that come in contact could turn red or white but will return to its normal colour after several hours.
- To avoid soft tissue irritation, advise the patient to avoid overfilling trays, to wipe away any excess gel from the gum line and to rinse the mouth thoroughly after the treatment.
- After each treatment, make sure patient replaces the syringe cap.
- The patient should not eat, drink or smoke tobacco for at least 60 minutes after each treatment.
- Instruct the patient to stop the treatment and contact the dental professional immediately if any problem develops.
- The final shade will be achieved about 2 weeks after the start of the treatment.

-WARNINGS

- Contains Fluoride.
- Contains Hydrogen Peroxide.
- Avoid contact with eyes.
- Keep out of reach of children.
- Avoid exposure of known hypersensitive teeth.
- Do no eat, drink or smoke while wearing the filled custom fitted trays.
- Harmful when swallowed.

FIRST AID INSTRUCTIONS

- If a large quantity (over 25% of the gel in the syringe) is swallowed, immediately drink water, do not induce vomiting and contact a doctor.
- If gel gets into eyes, hold eyelids apart and flush the eye continuously with running water for at least 15 minutes and contact a doctor.
- If clothing, skin or hair contact occurs, remove contaminated clothing and flush skin or hair with running water.

POTENTIAL ADVERSE EFFECTS

Adverse effects that may be associated with the use of InnoWhite RF-Refills include, but are not limited to:

Sensitivity

Some patients may experience increased tooth sensitivity to cold during the treatment, while others may have non-specific sensitivity in their teeth, gums, tongue, lips or throat. In general symptoms should disappear within 24 hours after the treatment is stopped. The treatment can be proceeded with shorter, less frequent applications until the desired whitening effect has been achieved. If the discomfort remains, discontinue the treatment.

Gingival Irritation

Trays that extend onto the gingiva may cause mild to severe soft tissue irritation. If the trays fit properly, check if the patient applies the proper quantity in the proper way. The patient may need to reduce the amount of gel in their trays.

STORAGE ADVICE

Store refrigerated (<8°C) in a dry place. Do not use the material after the expiry date.

DISPOSAL

Dispose of device in accordance with local waste regulations.

InnoWhite[®]
Professional Dental Whitening System



Made in Europe



Distributed by
ESSENTIAL INNOVATION PTE LTD
55 Ubi Ave 1 #02-10 Ubi 55
Singapore 408935.
Tel: +65-67426832
Email: info@inno-white.com

www.inno-white.com