

1 Activate with InnoWhite StainLess

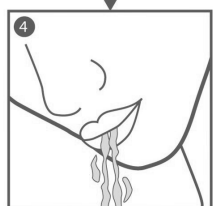

2 Brighten with InnoWhite Whitening Gel

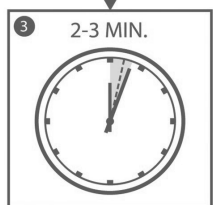
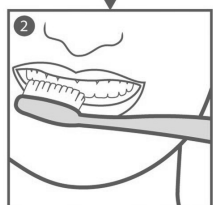
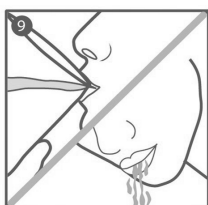
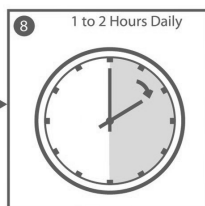
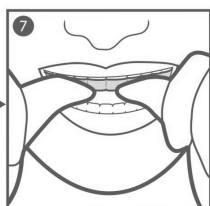
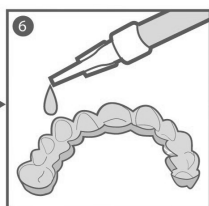
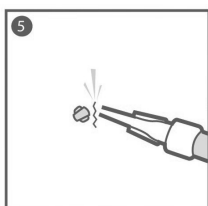

InnoWhite®

Professional Dental Whitening System

Instructions

1. Activate

1. Dispense InnoWhite StainLess onto toothbrush.
2. Brush the teeth thoroughly.
3. Clean teeth for 2 to 3 minutes.
4. Spit out any excess material. **Do not rinse with water.**

2. Whiten and Brighten

5. Break the tip off the syringe. (Reverse side of tip is a cap for syringe).
6. Apply 1 small drop of whitening gel onto each tooth area of the trays. Only apply on the inner front side of the trays.
7. Wear the upper and lower trays.
Remove any excess gel from the gum line with tissue.
8. Wear the trays for 1 to 2 hours daily.
9. After the treatment, remove the trays and rinse the mouth and trays thoroughly with water.

3. Condition

10. Apply InnoWhite Desensitizer onto the trays, on each tooth areas that are sensitive, if needed.
11. Wear upper and lower tray.
12. Keep the trays in the mouth for 5 to 10 minutes.
13. Remove trays and spit out any excess material.
Do not rinse mouth with water.
(Desensitizer is ingestible)

4. Store & Repeat

14. Clean the trays with a toothbrush, dry and store them in the case provided.
15. Repeat the treatment for 10 - 14 days.
Expect to see the whitening results after 5 - 7 days.

3 Condition with InnoWhite Desensitizer

